



*Projected Opening Fall 2024*

**ACRES:**

±0.49

**SQUARE FEET:**

±21,360

**ZONING:**

COMMERCIAL

**ADDRESS:**

432 N LINDSEY RD. MESA, ARIZONA 85213

**SUMMARY:**

Located in the heart of Mesa, Arizona, this EOS Fitness anchored grocery redevelopment is located on the northwest corner of University Dr and Lindsay Rd, which boasts combined traffic counts of over 40,000 vehicles per day. This center's trade area contains a population of over 325,000 with an average household income exceeding \$95,000.



**BARCLAY**  
GROUP

2415 E Camelback Rd, Suite 900  
Phoenix, Arizona, 85016  
[www.BarclayGroup.com](http://www.BarclayGroup.com)

**Brett Sheets**

Senior Vice President Leasing  
602.224.4147 Direct  
602.908.8837 Cell  
[bsheets@barclaygroup.com](mailto:bsheets@barclaygroup.com)

**Kristin Walrod**

Senior Leasing Manager  
602.224.4171 Direct  
480.521.4822 Cell  
[kwalrod@barclaygroup.com](mailto:kwalrod@barclaygroup.com)

**Matthew Archer**

Leasing Associate  
602.224.4160 Direct  
602.908.8680 Cell  
[marcher@barclaygroup.com](mailto:marcher@barclaygroup.com)

# SITE PLAN

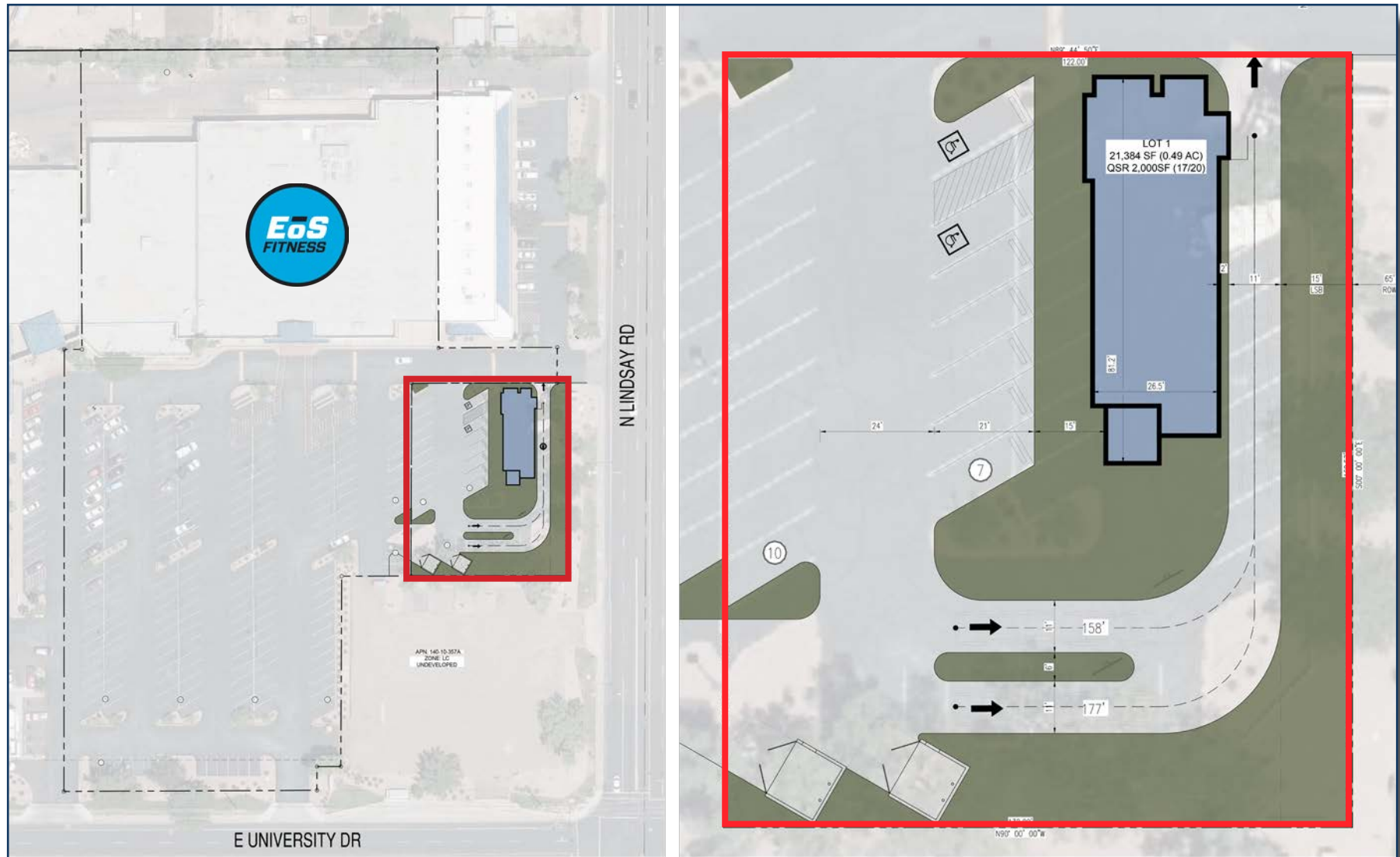

**BARCLAY**  
GROUP

2415 E Camelback Rd, Suite 900  
Phoenix, Arizona, 85016  
www.BarclayGroup.com

**Brett Sheets**  
Senior Vice President Leasing  
602.224.4147 Direct  
602.908.8837 Cell  
bsheets@barclaygroup.com

**Kristin Walrod**  
Senior Leasing Manager  
602.224.4171 Direct  
480.521.4822 Cell  
kwalrod@barclaygroup.com

**Matthew Archer**  
Leasing Associate  
602.224.4160 Direct  
602.908.8680 Cell  
marcher@barclaygroup.com



# MAPS

## KEY FACTS (5-Miles)

326,193

37.0

Population

Median Age



\$95,363

125,058  
Households

Average Household  
Income

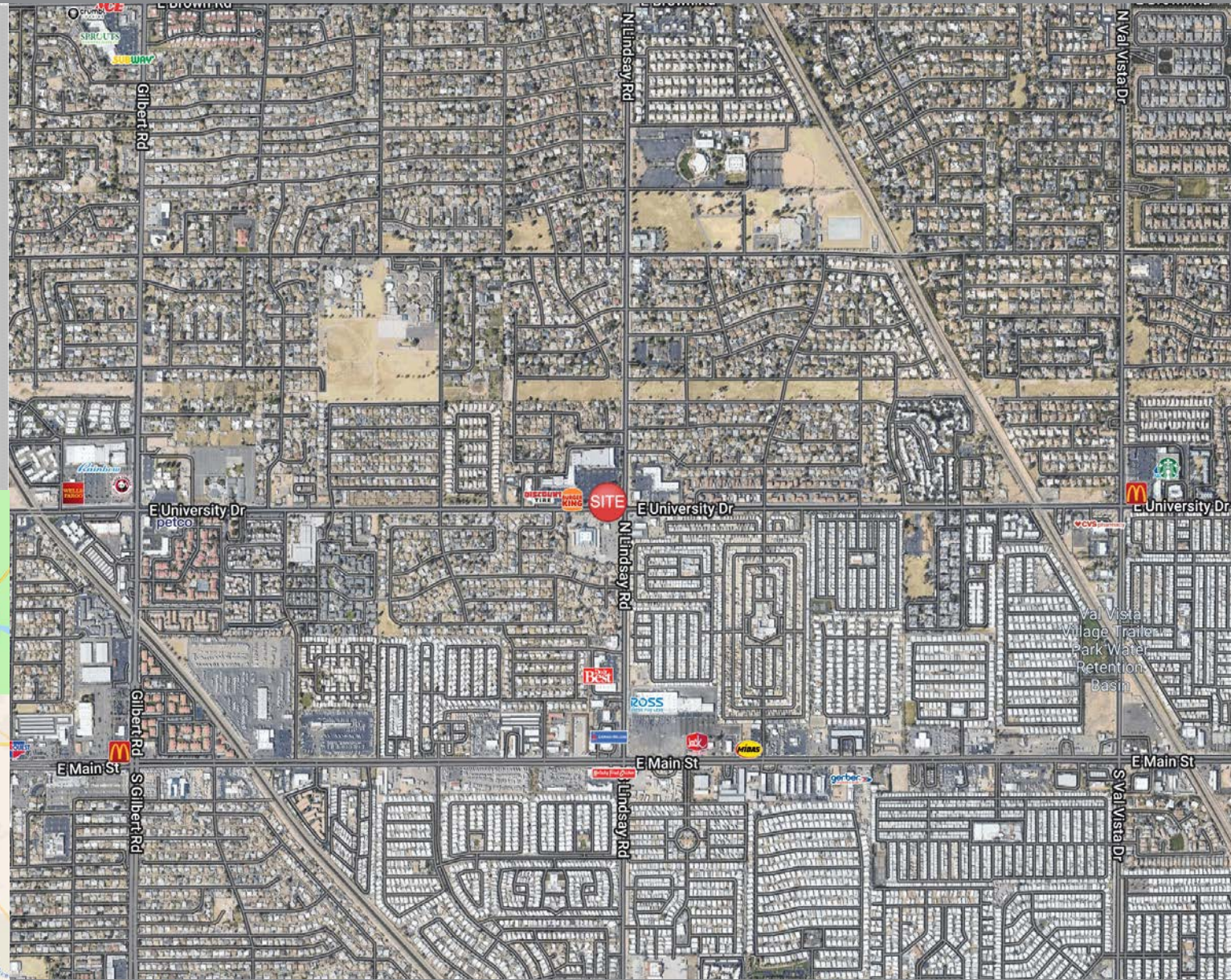
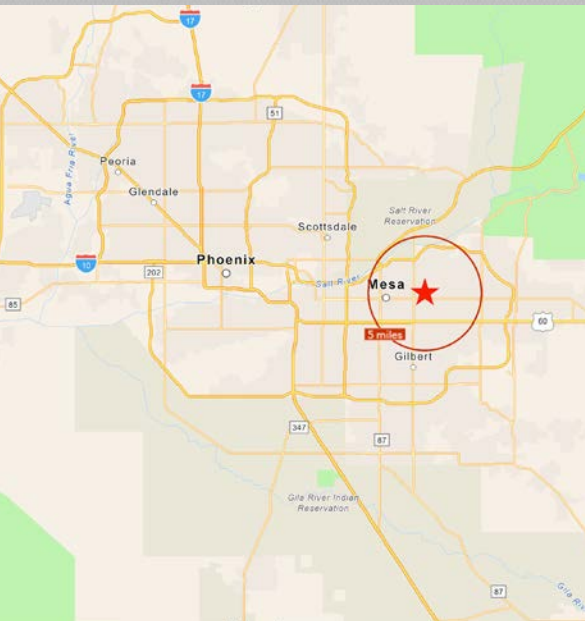

**BARCLAY**  
GROUP

2415 E Camelback Rd, Suite 900  
Phoenix, Arizona, 85016  
[www.BarclayGroup.com](http://www.BarclayGroup.com)

**Brett Sheets**  
Senior Vice President Leasing  
602.224.4147 Direct  
602.908.8837 Cell  
[bsheets@barclaygroup.com](mailto:bsheets@barclaygroup.com)

**Kristin Walrod**  
Senior Leasing Manager  
602.224.4171 Direct  
480.521.4822 Cell  
[kwalrod@barclaygroup.com](mailto:kwalrod@barclaygroup.com)

**Matthew Archer**  
Leasing Associate  
602.224.4160 Direct  
602.908.8680 Cell  
[marcher@barclaygroup.com](mailto:marcher@barclaygroup.com)

# DEMOGRAPHICS (5 MILES)

## ANNUAL HOUSEHOLD SPENDING



## INCOME



## Average Household Size

for this area

**2.58** which is more than the average for United States

Area	Value	0.00	4.00
04013 (Maricopa County)	2.63		
<b>This area</b>	<b>2.58</b>		
04 (Arizona)	2.57		
United States	2.53		

## KEY FACTS



## Tapestry Segments



Company/Business Name	Direction	Distance
Stafford Home & Patio LLC	SW	0.0
USPS	SW	0.0
Circle K	E	0.1
House of Used	W	0.1
E D's Smoke Shop	W	0.1
Great Clips	W	0.1
Dollar Tree	NW	0.1
Noble Nails	W	0.1
I Smoke Cigars & Vape	E	0.1
Discount Tire	W	0.1

Closest 10 locations

## EDUCATION

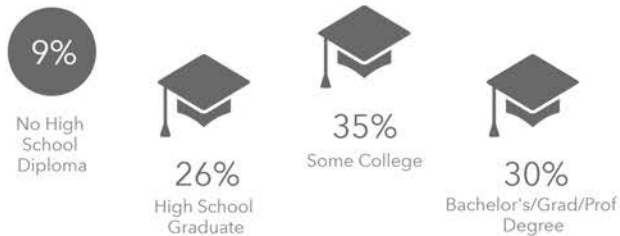

## ANNUAL LIFESTYLE SPENDING



**BARCLAY**  
GROUP

2415 E Camelback Rd, Suite 900  
Phoenix, Arizona, 85016  
www.BarclayGroup.com

**Brett Sheets**  
Senior Vice President Leasing  
602.224.4147 Direct  
602.908.8837 Cell  
bsheets@barclaygroup.com

**Kristin Walrod**  
Senior Leasing Manager  
602.224.4171 Direct  
480.521.4822 Cell  
kwalrod@barclaygroup.com

**Matthew Archer**  
Leasing Associate  
602.224.4160 Direct  
602.908.8680 Cell  
marcher@barclaygroup.com