

# CITY GATE MARKETPLACE | GILBERT, AZ



**ADDRESS:**  
SEC BASELINE AND HIGLEY ROADS GILBERT, ARIZONA

**SUMMARY:**  
One block from the US 60 with high traffic flow of 35,396 VPD and 21,970 VPD at main intersection by center corner. High income area with 170,000 workforce within 10 min drive. 1/2-mile from Banner Gateway Medical Center - 60 acre campus with 177 private rooms, nine operating suites, and an Emergency Department with 37 private treatment rooms. Ideal location for residents coming and going from commutes.



**BARCLAY**  
GROUP

2415 E Camelback Rd, Suite 900  
Phoenix, Arizona, 85016  
[www.BarclayGroup.com](http://www.BarclayGroup.com)

**Brett Sheets**  
*Senior Vice President Leasing*  
602.224.4147 Direct  
602.908.8837 Cell  
[bsheets@barclaygroup.com](mailto:bsheets@barclaygroup.com)

**Kristin Walrod**  
*Senior Leasing Manager*  
602.224.4171 Direct  
480.521.4822 Cell  
[kwalrod@barclaygroup.com](mailto:kwalrod@barclaygroup.com)

**Matthew Archer**  
*Leasing Associate*  
602.224.4160 Direct  
602.908.8680 Cell  
[marcher@barclaygroup.com](mailto:marcher@barclaygroup.com)

# CITY GATE MARKETPLACE | SITE PLAN

HIGLEY RD ±34,400 VPD

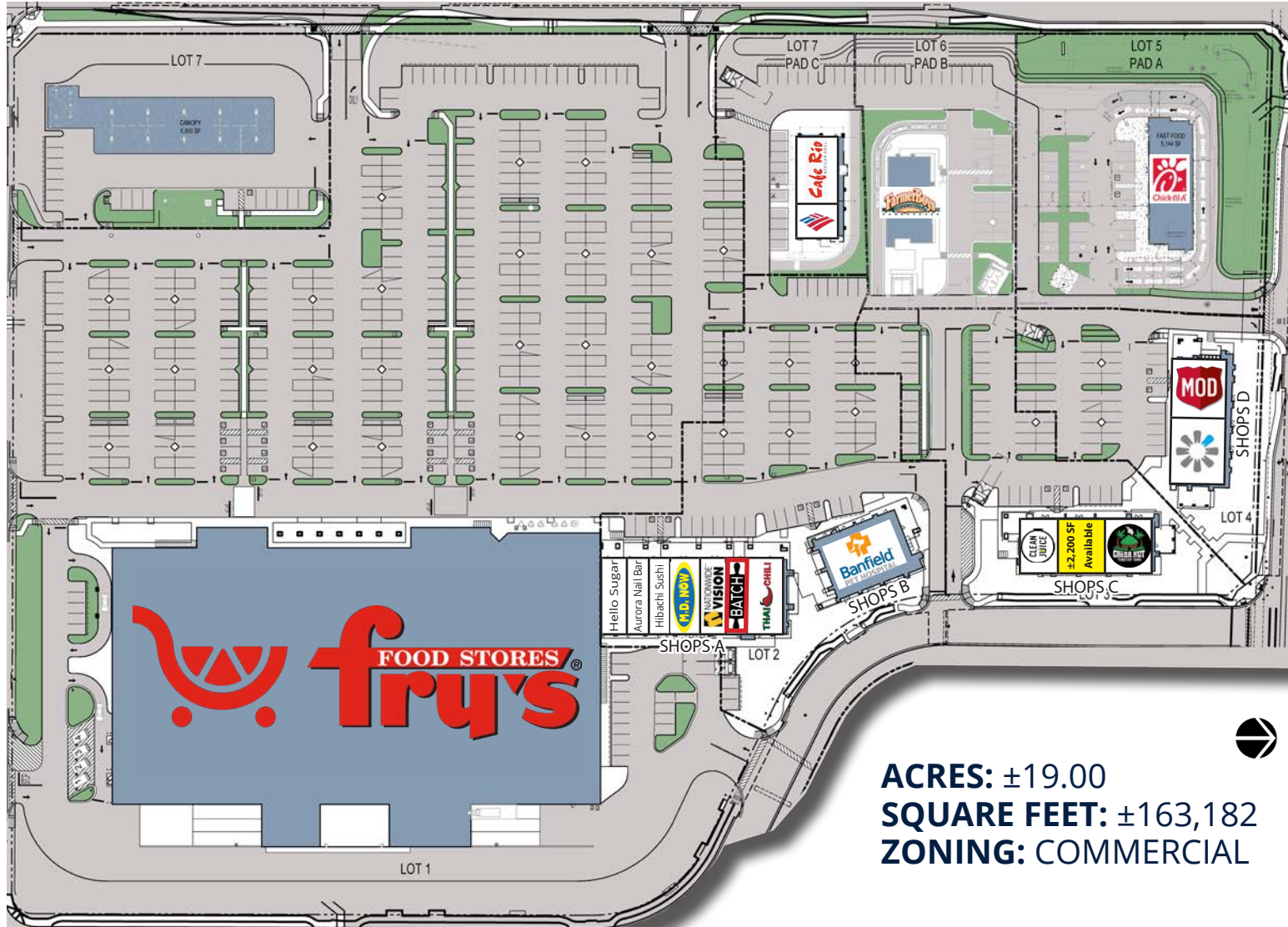

BASELINE RD ±21,000 VPD

**ACRES: ±19.00**  
**SQUARE FEET: ±163,182**  
**ZONING: COMMERCIAL**



**BARCLAY**  
GROUP

2415 E Camelback Rd, Suite 900  
 Phoenix, Arizona, 85016  
[www.BarclayGroup.com](http://www.BarclayGroup.com)

**Brett Sheets**  
 Senior Vice President Leasing  
 602.224.4147 Direct  
 602.908.8837 Cell  
[bsheets@barclaygroup.com](mailto:bsheets@barclaygroup.com)

**Kristin Walrod**  
 Senior Leasing Manager  
 602.224.4171 Direct  
 480.521.4822 Cell  
[kwalrod@barclaygroup.com](mailto:kwalrod@barclaygroup.com)

**Matthew Archer**  
 Leasing Associate  
 602.224.4160 Direct  
 602.908.8680 Cell  
[marcher@barclaygroup.com](mailto:marcher@barclaygroup.com)



# CITY GATE MARKETPLACE | SHOPS A

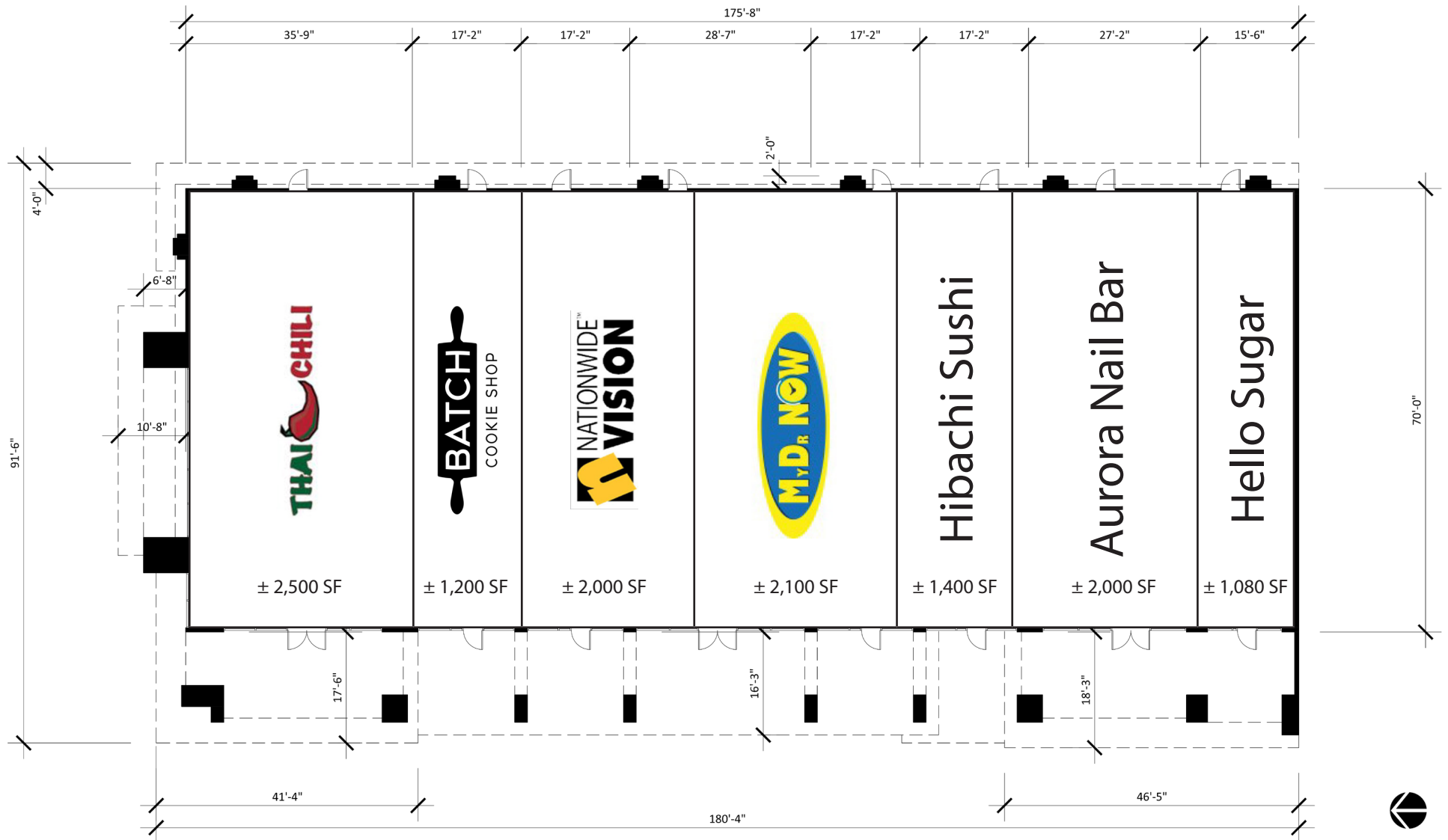

**BARCLAY**  
GROUP

2415 E Camelback Rd, Suite 900  
Phoenix, Arizona, 85016  
www.BarclayGroup.com

**Brett Sheets**  
Senior Vice President Leasing  
602.224.4147 Direct  
602.908.8837 Cell  
bsheets@barclaygroup.com

**Kristin Walrod**  
Senior Leasing Manager  
602.224.4171 Direct  
480.521.4822 Cell  
kwalrod@barclaygroup.com

**Matthew Archer**  
Leasing Associate  
602.224.4160 Direct  
602.908.8680 Cell  
marcher@barclaygroup.com



# CITY GATE MARKETPLACE | SHOPS B

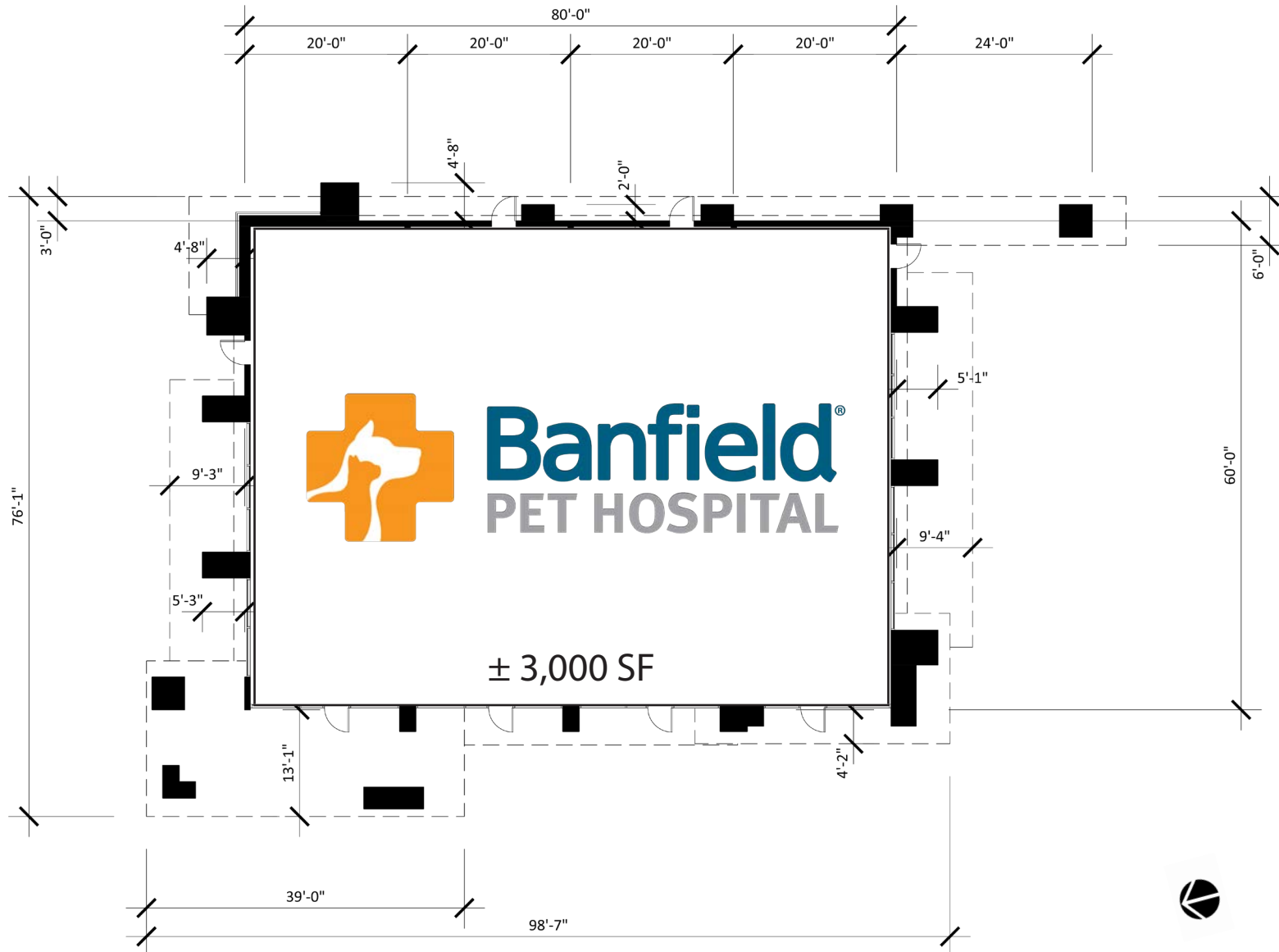

**BARCLAY**  
GROUP

2415 E Camelback Rd, Suite 900  
Phoenix, Arizona, 85016  
[www.BarclayGroup.com](http://www.BarclayGroup.com)

**Brett Sheets**  
Senior Vice President Leasing  
602.224.4147 Direct  
602.908.8837 Cell  
[bsheets@barclaygroup.com](mailto:bsheets@barclaygroup.com)

**Kristin Walrod**  
Senior Leasing Manager  
602.224.4171 Direct  
480.521.4822 Cell  
[kwalrod@barclaygroup.com](mailto:kwalrod@barclaygroup.com)

**Matthew Archer**  
Leasing Associate  
602.224.4160 Direct  
602.908.8680 Cell  
[marcher@barclaygroup.com](mailto:marcher@barclaygroup.com)

# CITY GATE MARKETPLACE | SHOPS C

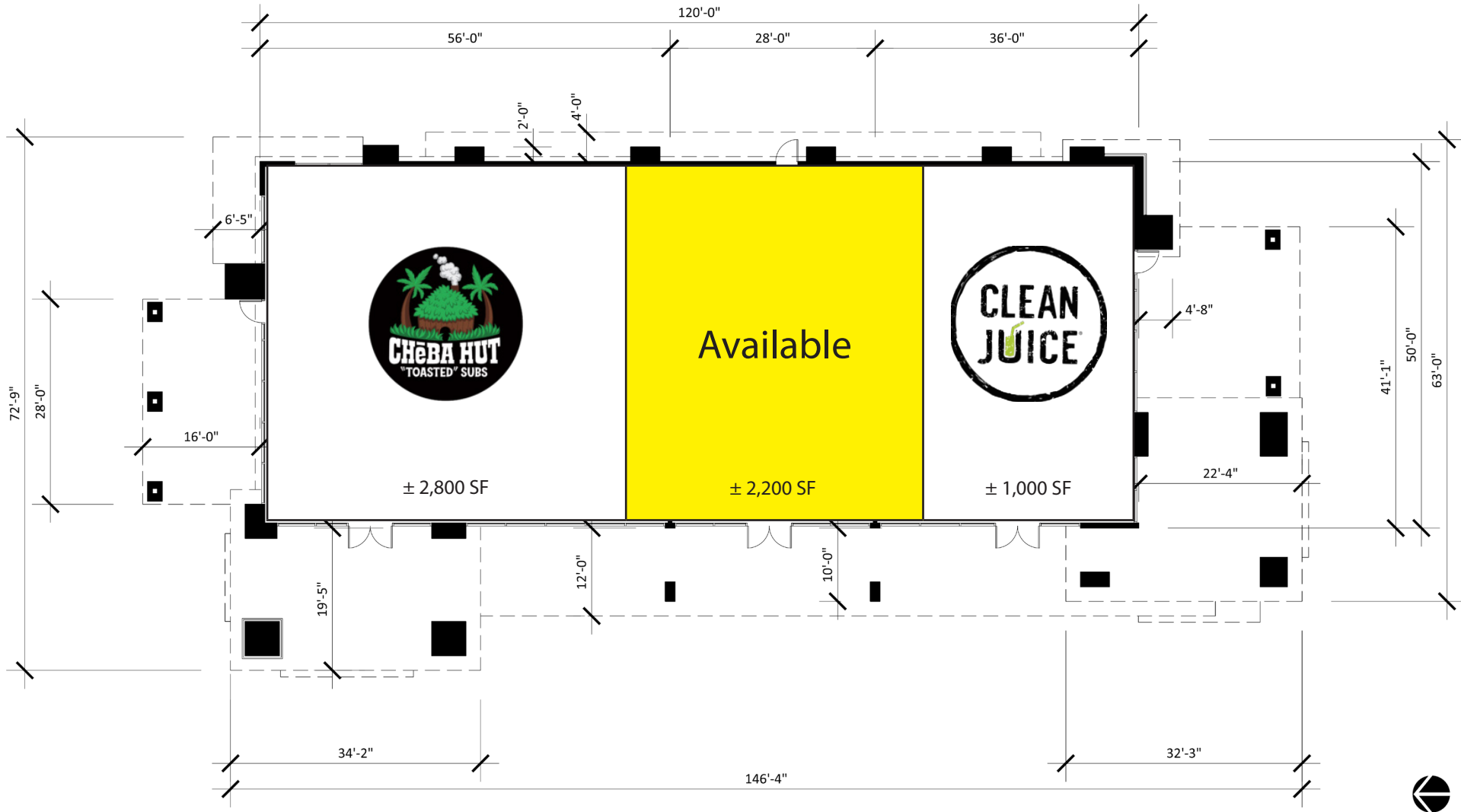

**BARCLAY**  
GROUP

2415 E Camelback Rd, Suite 900  
Phoenix, Arizona, 85016  
www.BarclayGroup.com

**Brett Sheets**  
Senior Vice President Leasing  
602.224.4147 Direct  
602.908.8837 Cell  
bsheets@barclaygroup.com

**Kristin Walrod**  
Senior Leasing Manager  
602.224.4171 Direct  
480.521.4822 Cell  
kwalrod@barclaygroup.com

**Matthew Archer**  
Leasing Associate  
602.224.4160 Direct  
602.908.8680 Cell  
marcher@barclaygroup.com

# CITY GATE MARKETPLACE | SHOPS D

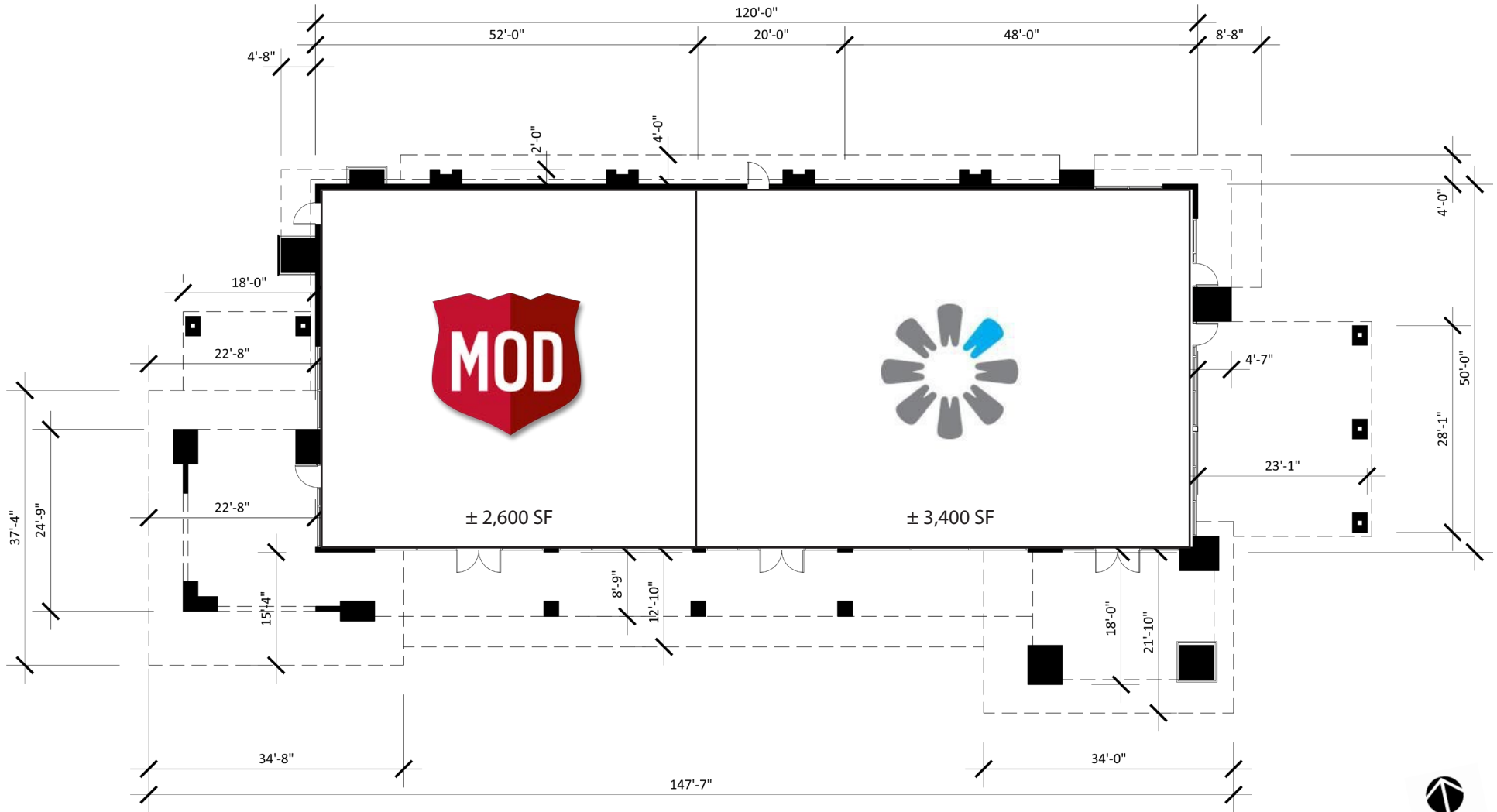

**BARCLAY**  
GROUP

2415 E Camelback Rd, Suite 900  
Phoenix, Arizona, 85016  
[www.BarclayGroup.com](http://www.BarclayGroup.com)

**Brett Sheets**  
Senior Vice President Leasing  
602.224.4147 Direct  
602.908.8837 Cell  
[bsheets@barclaygroup.com](mailto:bsheets@barclaygroup.com)

**Kristin Walrod**  
Senior Leasing Manager  
602.224.4171 Direct  
480.521.4822 Cell  
[kwalrod@barclaygroup.com](mailto:kwalrod@barclaygroup.com)

**Matthew Archer**  
Leasing Associate  
602.224.4160 Direct  
602.908.8680 Cell  
[marcher@barclaygroup.com](mailto:marcher@barclaygroup.com)

# CITY GATE MARKETPLACE | AERIAL

## KEY FACTS (5-Miles)

334,662

Population



127,687  
Households

38.1

Median Age

\$101,359

Average Household  
Income

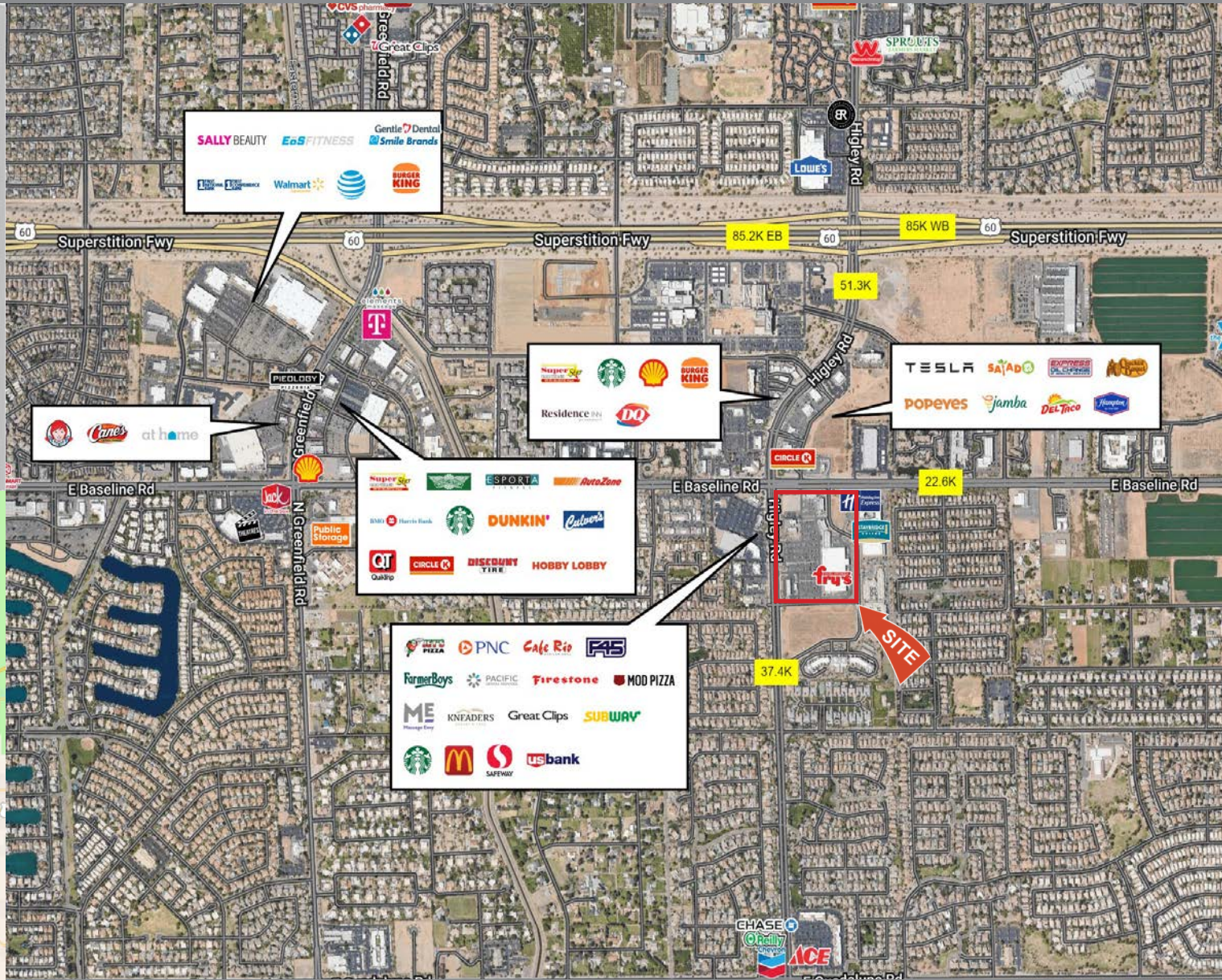
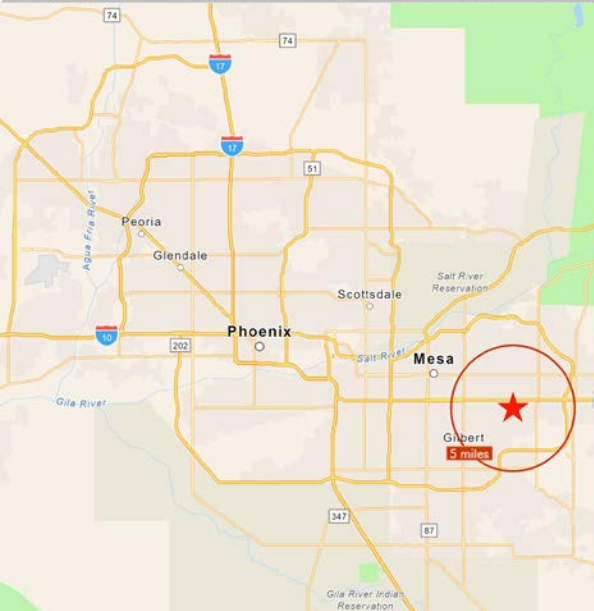

**BARCLAY**  
GROUP

2415 E Camelback Rd, Suite 900  
Phoenix, Arizona, 85016  
www.BarclayGroup.com

**Brett Sheets**  
Senior Vice President Leasing  
602.224.4147 Direct  
602.908.8837 Cell  
bsheets@barclaygroup.com

**Kristin Walrod**  
Senior Leasing Manager  
602.224.4171 Direct  
480.521.4822 Cell  
kwalrod@barclaygroup.com

**Matthew Archer**  
Leasing Associate  
602.224.4160 Direct  
602.908.8680 Cell  
marcher@barclaygroup.com

# CITY GATE MARKETPLACE | 5-MILE DEMOS

## ANNUAL HOUSEHOLD SPENDING



## INCOME



## Average Household Size

for this area

**2.58** which is more than the average for United States

Area	Value	0.00	4.00
04013 (Maricopa County)	2.63		
<b>This area</b>	<b>2.58</b>		
04 (Arizona)	2.57		
United States	2.53		

## KEY FACTS

**335,763**

Population

**38.2**

Median Age



**128,931**

Households

**\$65,029**

Median Disposable Income

## EDUCATION

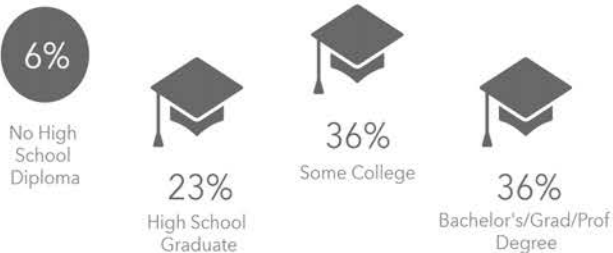

## Tapestry Segments

<b>7A</b>	<b>Up and Coming Families</b> 22,117 households	<b>17.2%</b> of Households	▼
<b>9C</b>	<b>The Elders</b> 19,054 households	<b>14.8%</b> of Households	▼
<b>4A</b>	<b>Workday Drive</b> 13,319 households	<b>10.3%</b> of Households	▼

## ANNUAL LIFESTYLE SPENDING



Company/Business Name	Direction	Distance
Supercuts	E	0.1
Aurora Nail Bar	E	0.1
Banfield Pet Hospital	NE	0.1
Fry's Food	E	0.1
Massage Envy	W	0.1
Great Clips	W	0.1
Ultra Nails & Spa	W	0.1
Firestone Complete Auto Care	W	0.1
Safeway	W	0.1
Staybridge Suites Phoenix East-Gilbert	NE	0.2

Closest 10 locations



**BARCLAY**  
GROUP

2415 E Camelback Rd, Suite 900  
Phoenix, Arizona, 85016  
www.BarclayGroup.com

**Brett Sheets**  
Senior Vice President Leasing  
602.224.4147 Direct  
602.908.8837 Cell  
bsheets@barclaygroup.com

**Kristin Walrod**  
Senior Leasing Manager  
602.224.4171 Direct  
480.521.4822 Cell  
kwalrod@barclaygroup.com

**Matthew Archer**  
Leasing Associate  
602.224.4160 Direct  
602.908.8680 Cell  
marcher@barclaygroup.com